

Inking in Digital Painting

lastname.pencilsketch @ 25% (Layer 1, RGB/8) *

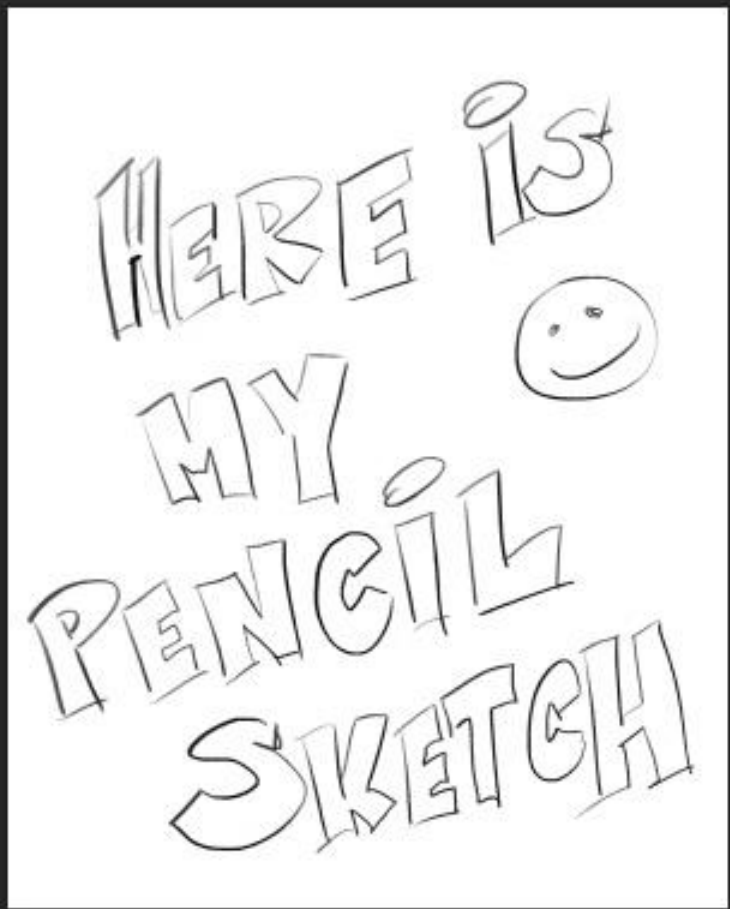

- History
- Brush Tool
- Brush Tool
- Brush Tool
- Brush Tool
- Brush Tool
- Brush Tool
- Brush Tool

Navigator Histogram



25%

Tool Presets

- Eraser Brush
- Glazing Brush
- Ink Brush
- Paint Brush
- Pencil Brush

After you have completed your pencil sketch and only have your *one best layer* visible...

Layers Channels Paths

Kind Opacity: 100%

Normal Opacity: 100%

Lock: Fill: 100%

- Layer 1
- Background

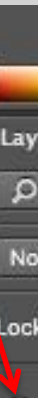

25%

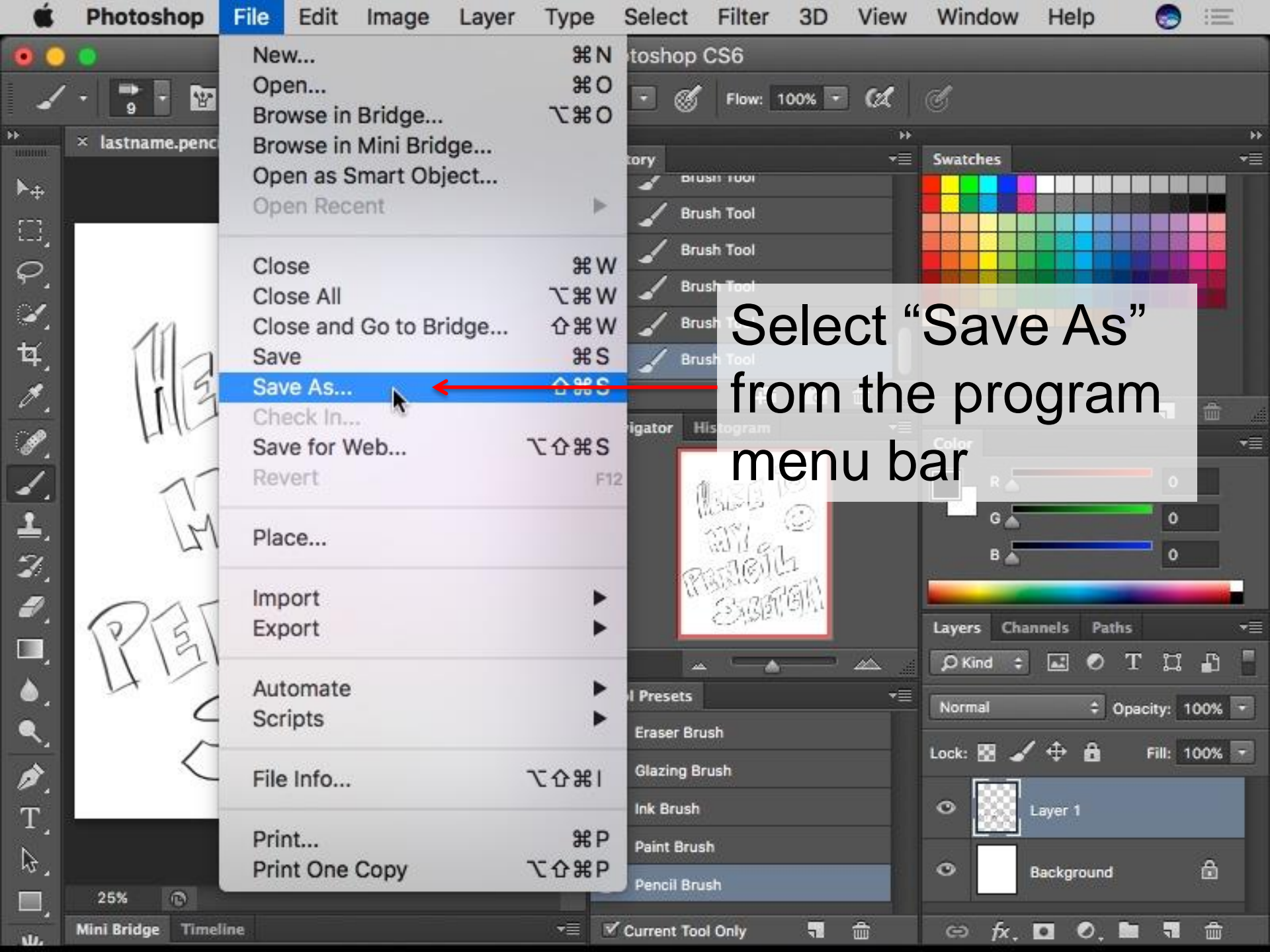

- New... ⌘N
- Open... ⌘O
- Browse in Bridge... ⇧⌘O
- Browse in Mini Bridge...
- Open as Smart Object...
- Open Recent
- Close ⌘W
- Close All ⇧⌘W
- Close and Go to Bridge... ⌥⌘W
- Save ⌘S
- Save As... ⌥⌘S**
- Check In...
- Save for Web... ⇧⌥⌘S
- Revert F12
- Place...
- Import
- Export
- Automate
- Scripts
- File Info... ⇧⌥⌘I
- Print... ⌘P
- Print One Copy ⇧⌥⌘P

Select "Save As" from the program menu bar

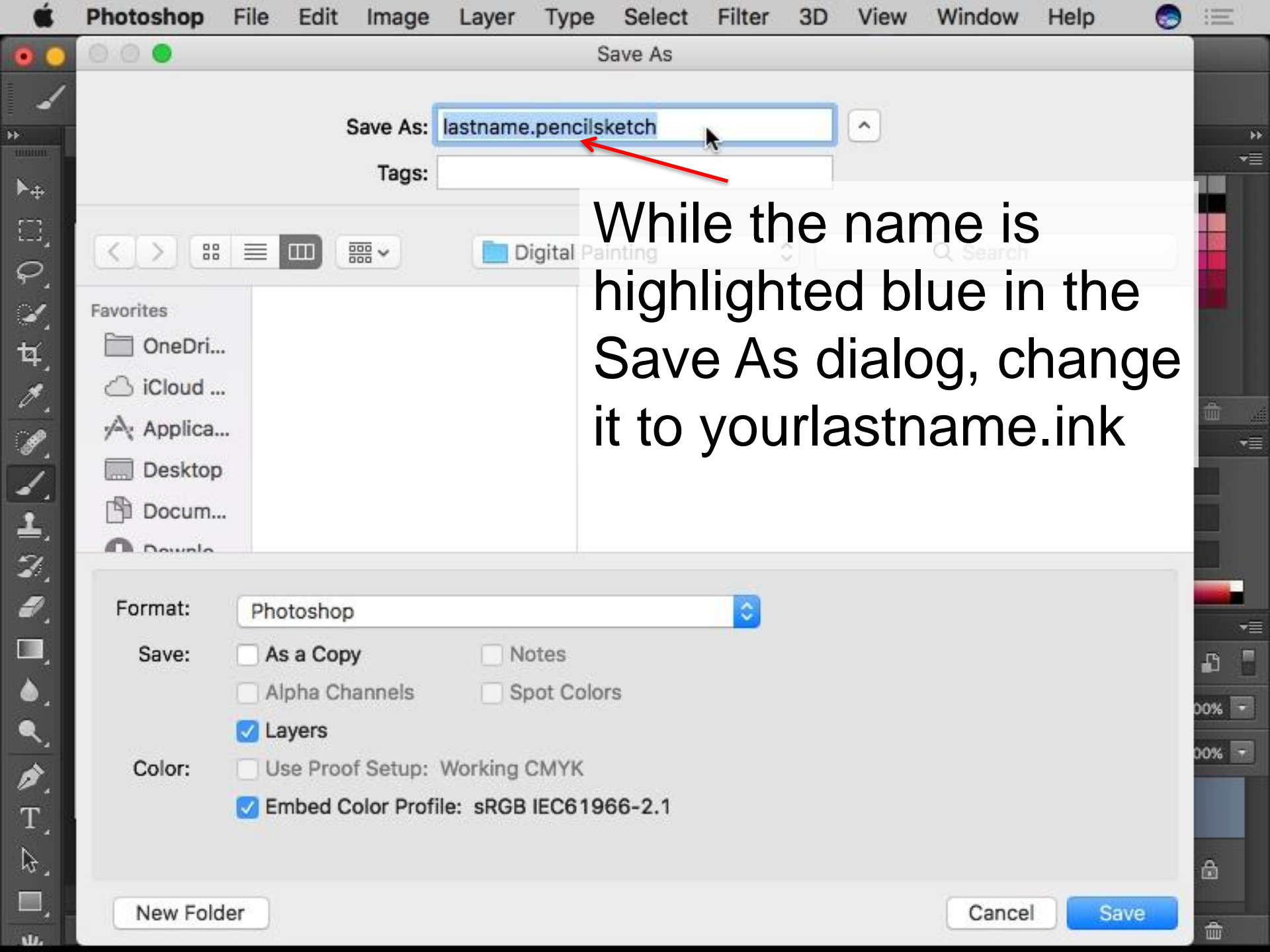

Save As: lastname.pencilsketch

Tags:

While the name is highlighted blue in the Save As dialog, change it to yourlastname.ink

Navigation icons: back, forward, view, compare, compare with previous, compare with next, compare with original, compare with previous and next, compare with original and previous, compare with original and next.

Digital Painting

Search

Favorites

- OneDri...
- iCloud ...
- Applica...
- Desktop
- Docum...
- Double

Format: Photoshop

- Save:
- As a Copy
 - Notes
 - Alpha Channels
 - Spot Colors

Layers

- Color:
- Use Proof Setup: Working CMYK
 - Embed Color Profile: sRGB IEC61966-2.1

New Folder

Cancel

Save

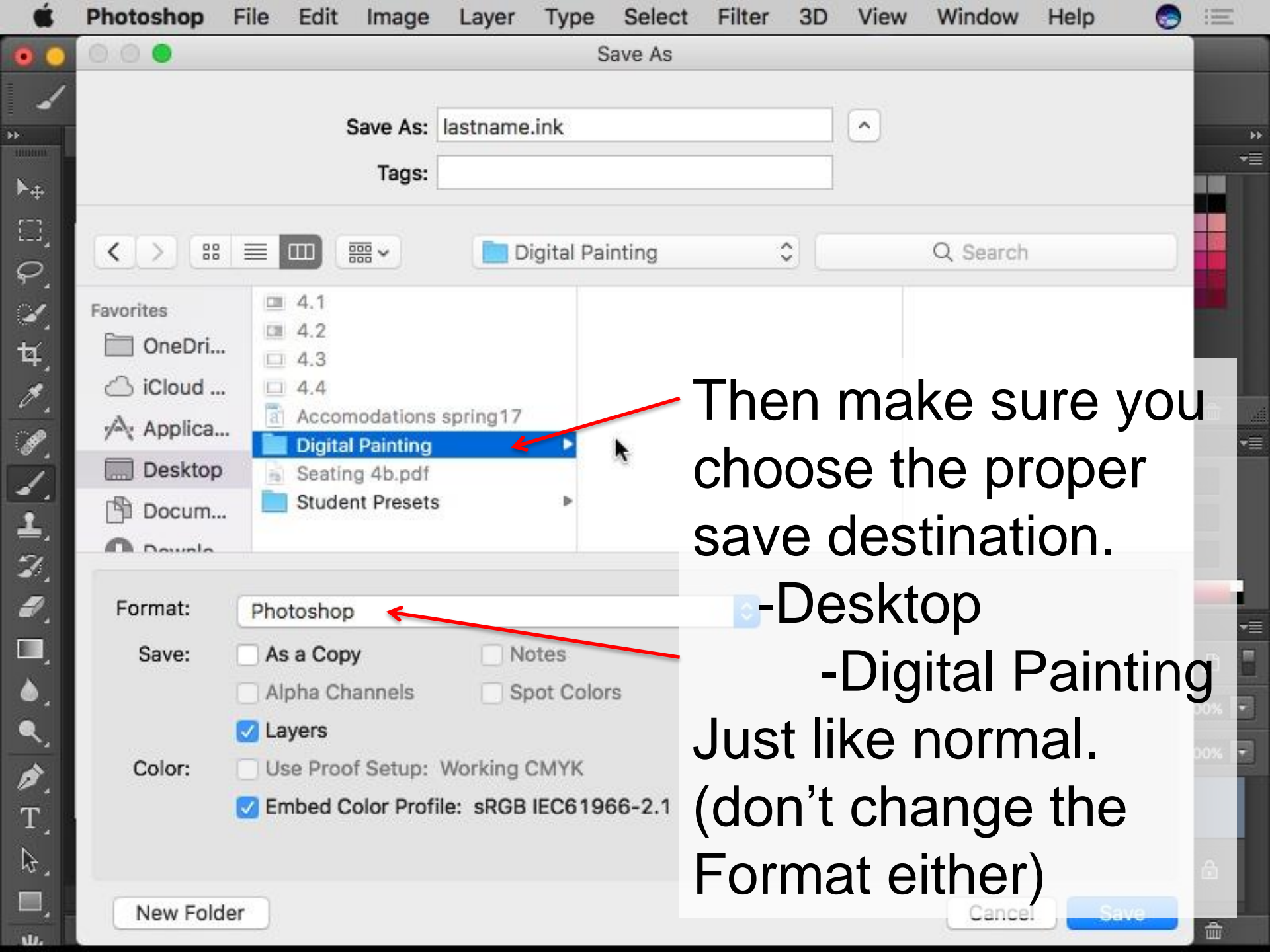

Save As: lastname.ink

Tags:

Digital Painting

Search

Favorites

- OneDri...
- iCloud ...
- Applica...
- Desktop
- Docum...
- Double

- 4.1
- 4.2
- 4.3
- 4.4
- Accommodations spring17
- Digital Painting**
- Seating 4b.pdf
- Student Presets

Then make sure you choose the proper save destination.

- Desktop
- Digital Painting

Just like normal. (don't change the Format either)

Format: Photoshop

- Save: As a Copy Notes
- Alpha Channels Spot Colors
- Layers

- Color: Use Proof Setup: Working CMYK
- Embed Color Profile: sRGB IEC61966-2.1

New Folder

Cancel Save

Save As

Save As: lastname.ink

Tags:

Digital Painting Search

Favorites

- OneDri...
- iCloud ...
- Applica...
- Desktop
- Docum...
- Double

- 4.1
- 4.2
- 4.3
- 4.4
- Accommodations spring17
- Digital Painting
- Seating 4b.pdf
- Student Presets

Format: Photoshop

- Save: As a Copy Notes
- Alpha Channels Spot Colors

Layers

- Color: Use Proof Setup: Working CMYK
- Embed Color Profile: sRGB IEC61966-2.1

Then just save



New Folder

Cancel

Save

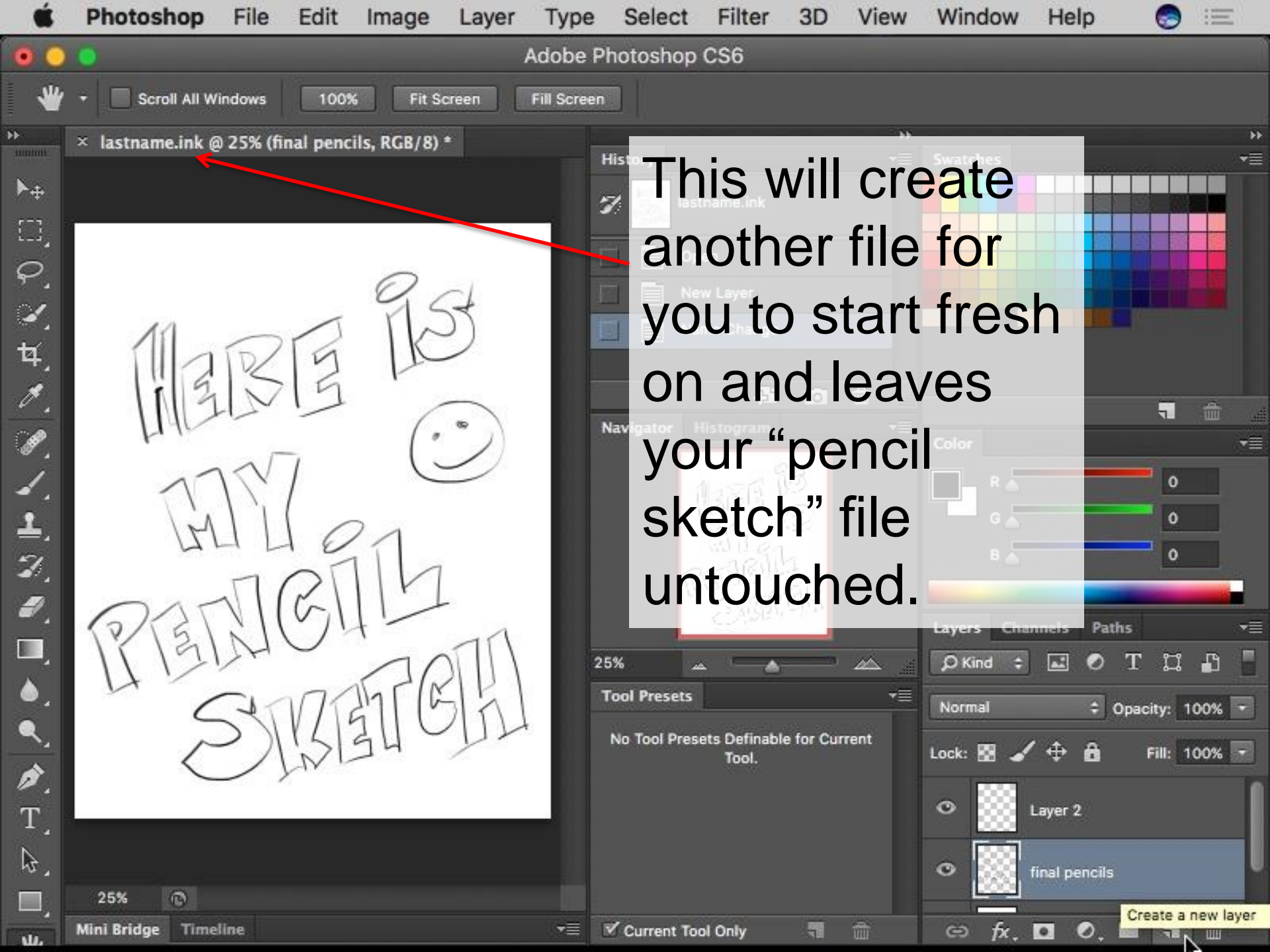

This will create another file for you to start fresh on and leaves your "pencil sketch" file untouched.

Create a new layer

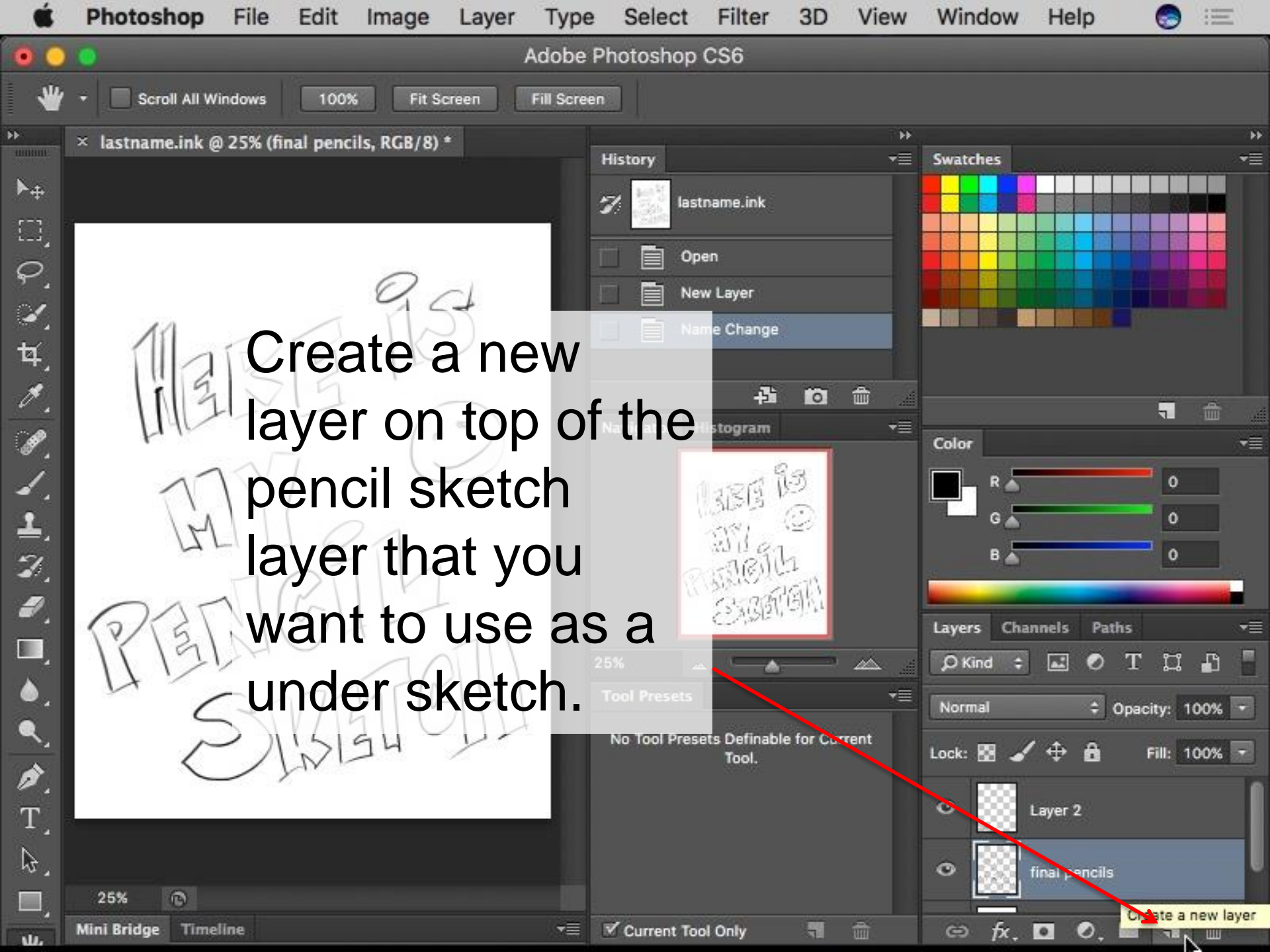

Create a new layer on top of the pencil sketch layer that you want to use as a under sketch.

Create a new layer

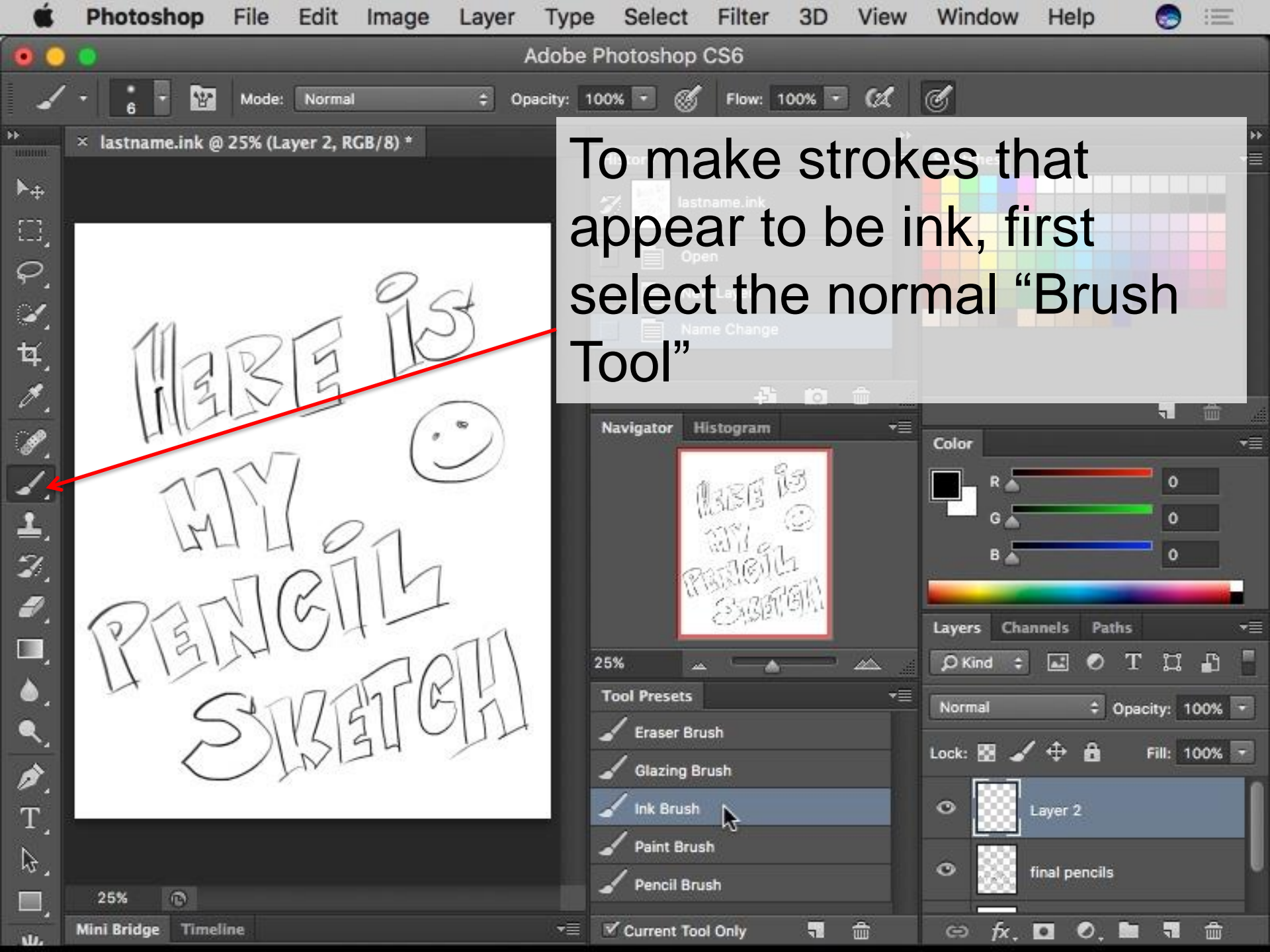

To make strokes that appear to be ink, first select the normal "Brush Tool"

HERE IS
MY
PENCIL
SKETCH



- Eraser Brush
- Glazing Brush
- Ink Brush**
- Paint Brush
- Pencil Brush

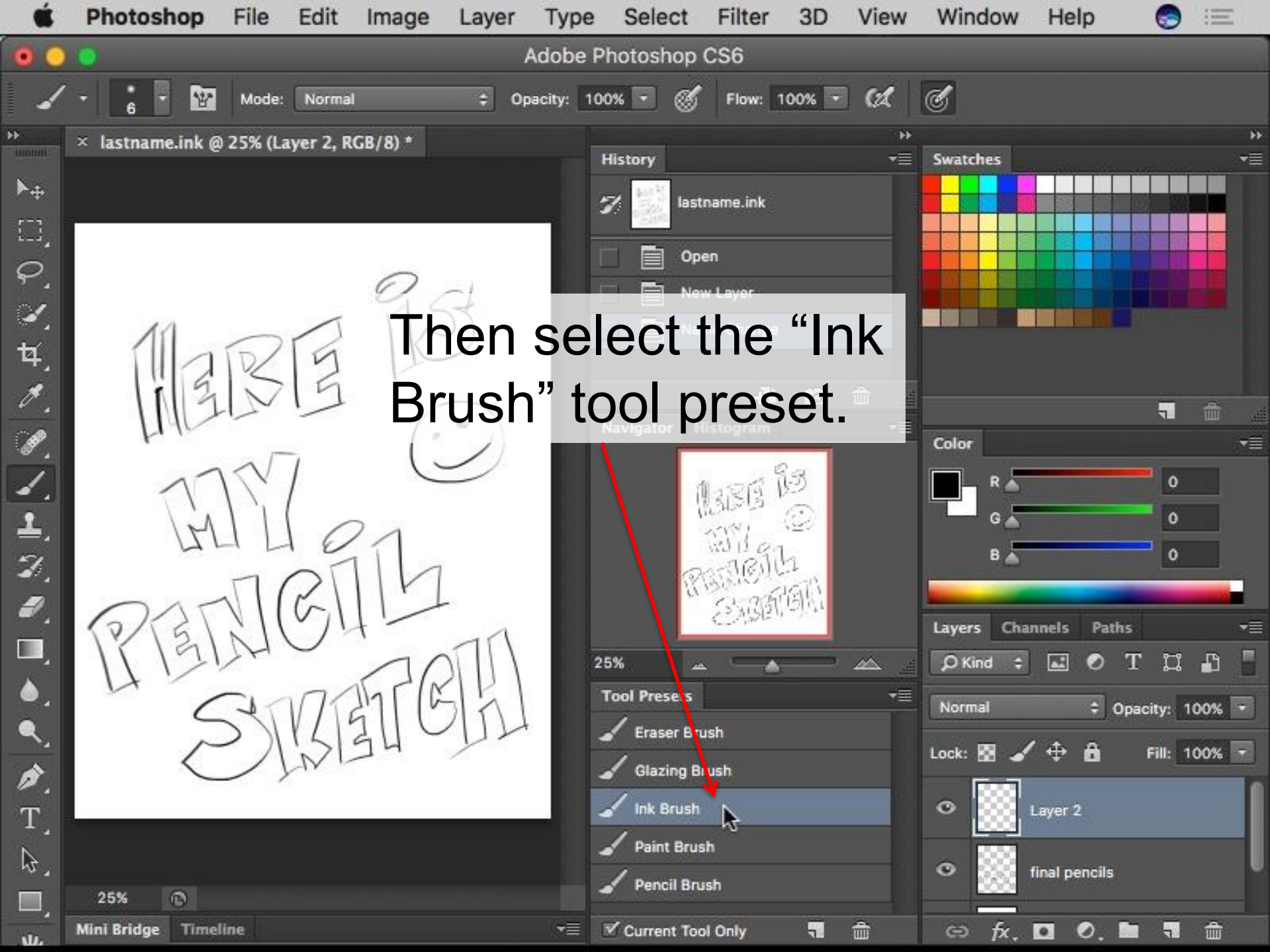

Then select the "Ink Brush" tool preset.

- Eraser Brush
- Glazing Brush
- Ink Brush**
- Paint Brush
- Pencil Brush

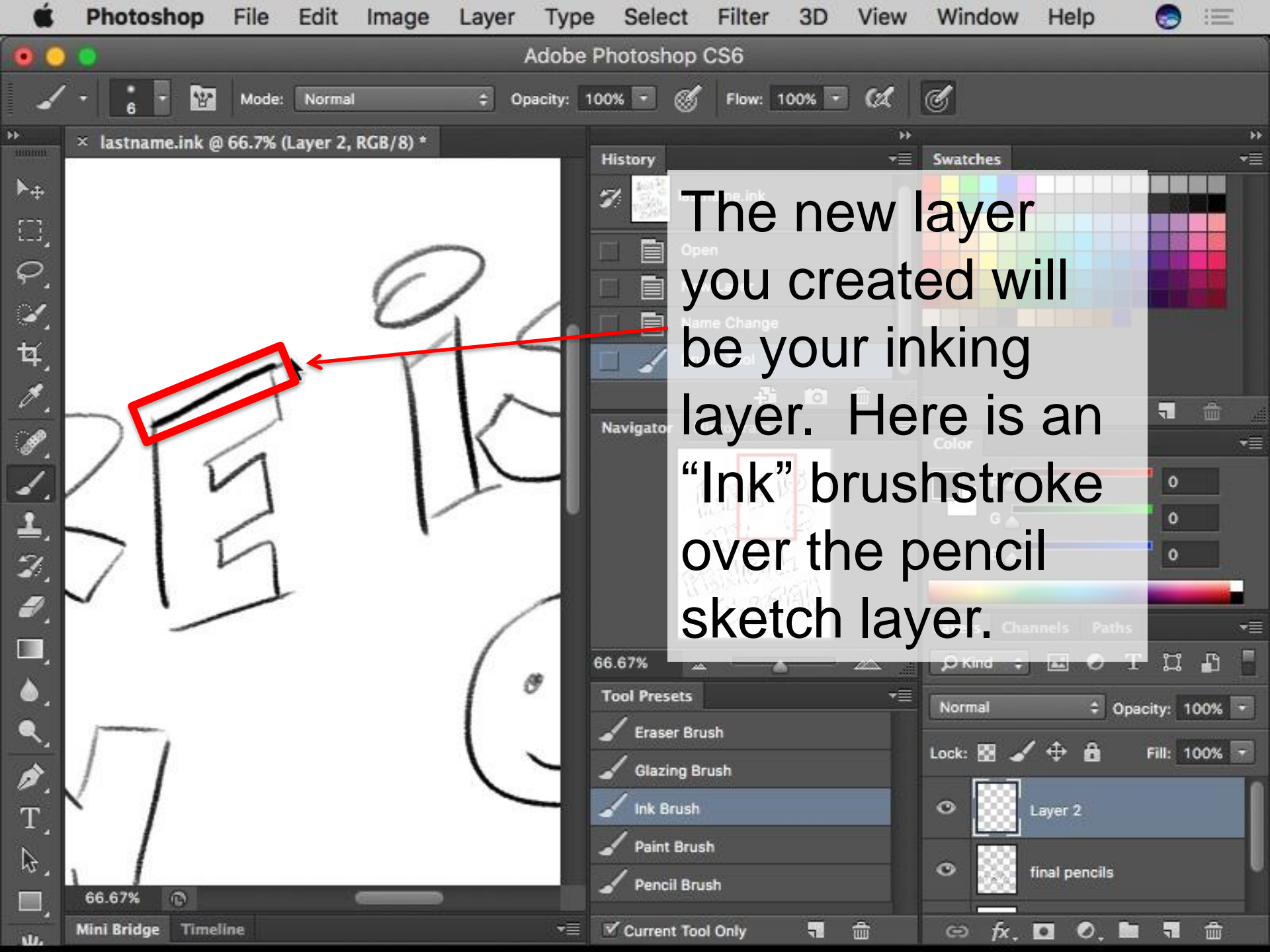

The new layer you created will be your inking layer. Here is an “Ink” brushstroke over the pencil sketch layer.

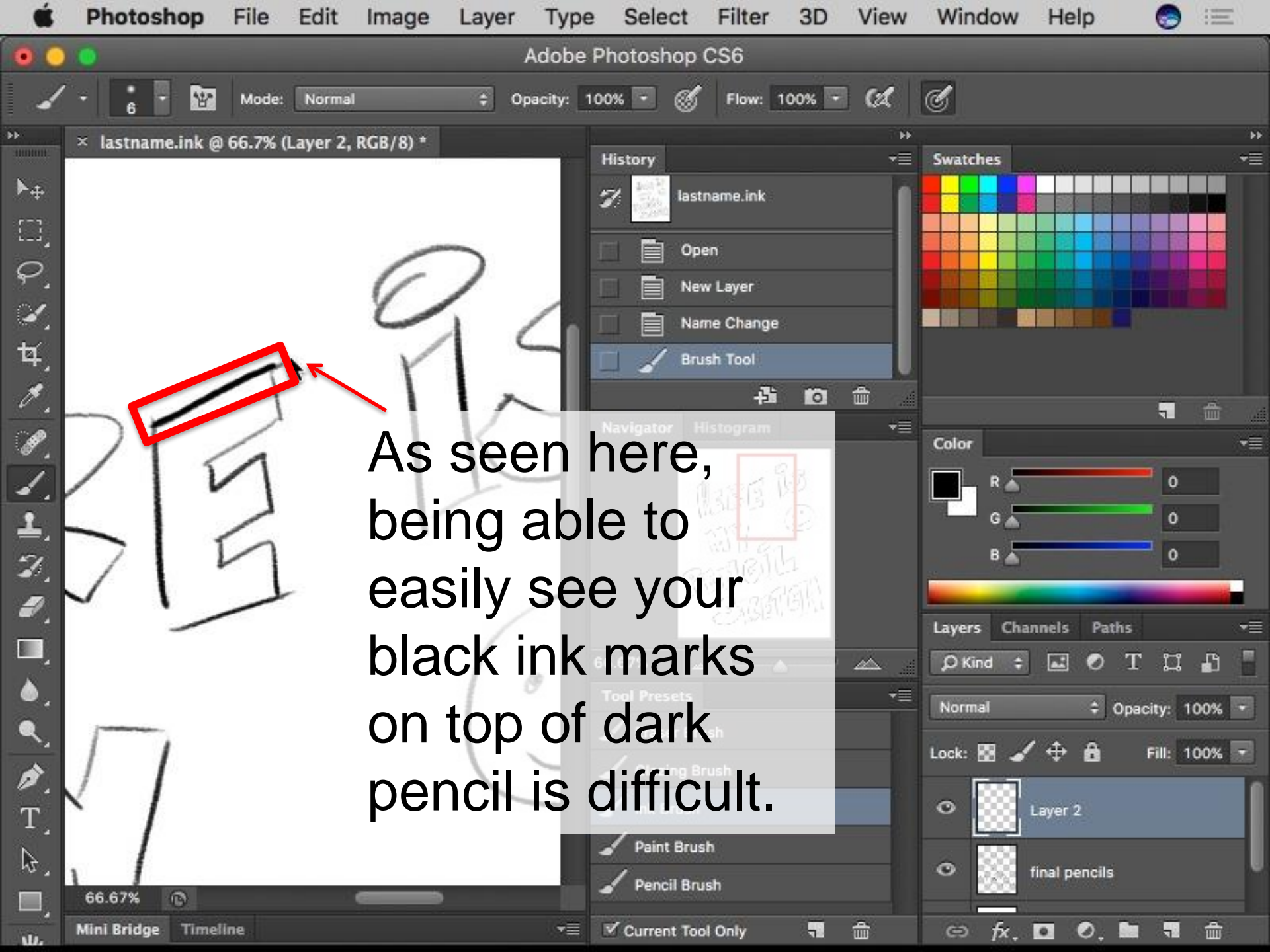

As seen here, being able to easily see your black ink marks on top of dark pencil is difficult.

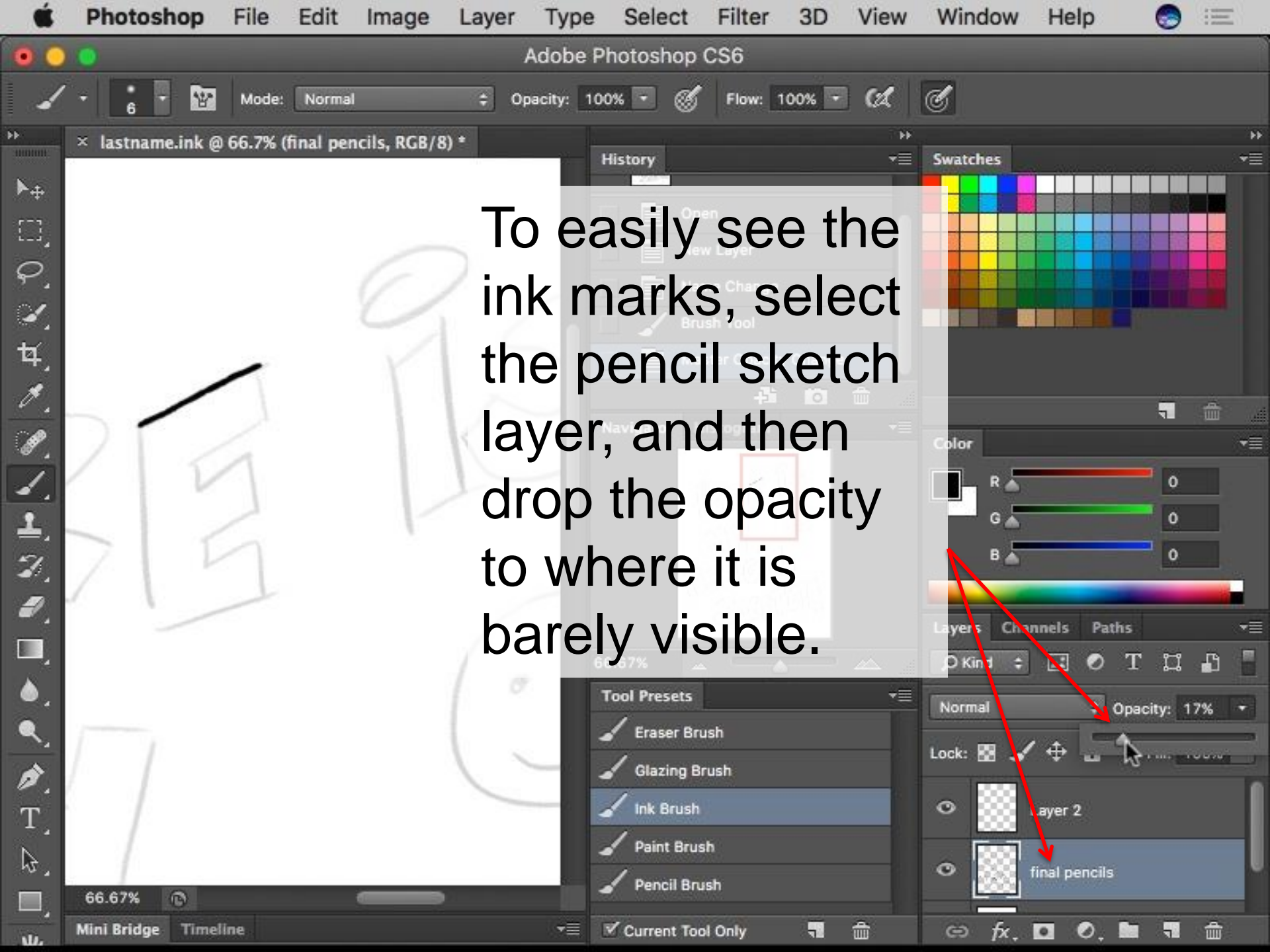

To easily see the ink marks, select the pencil sketch layer, and then drop the opacity to where it is barely visible.

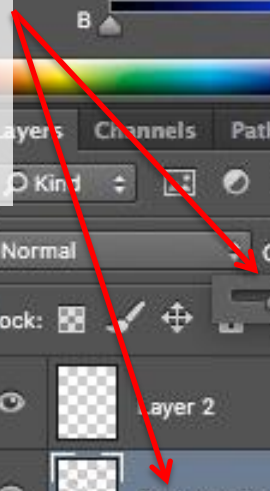

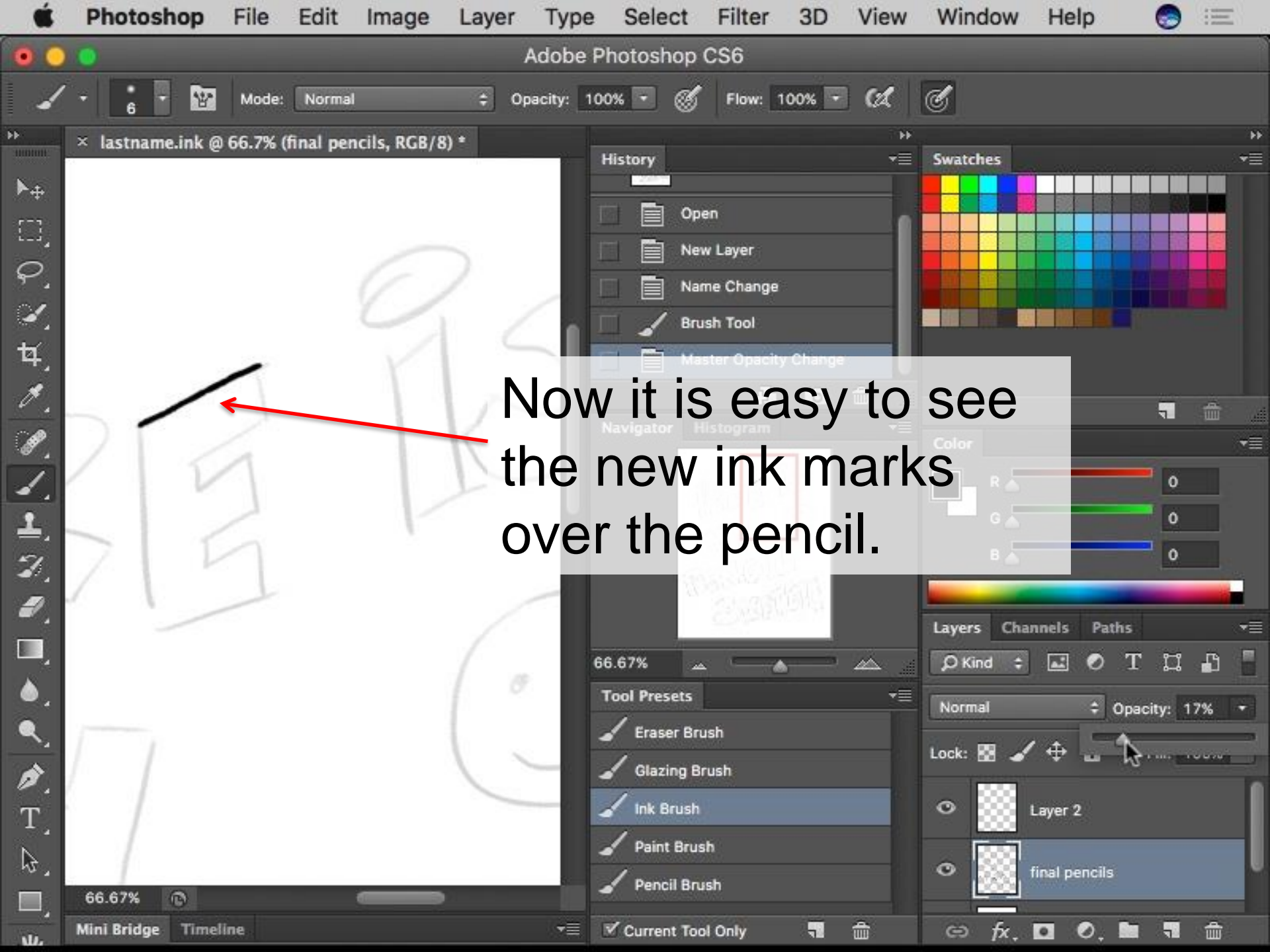

Now it is easy to see the new ink marks over the pencil.

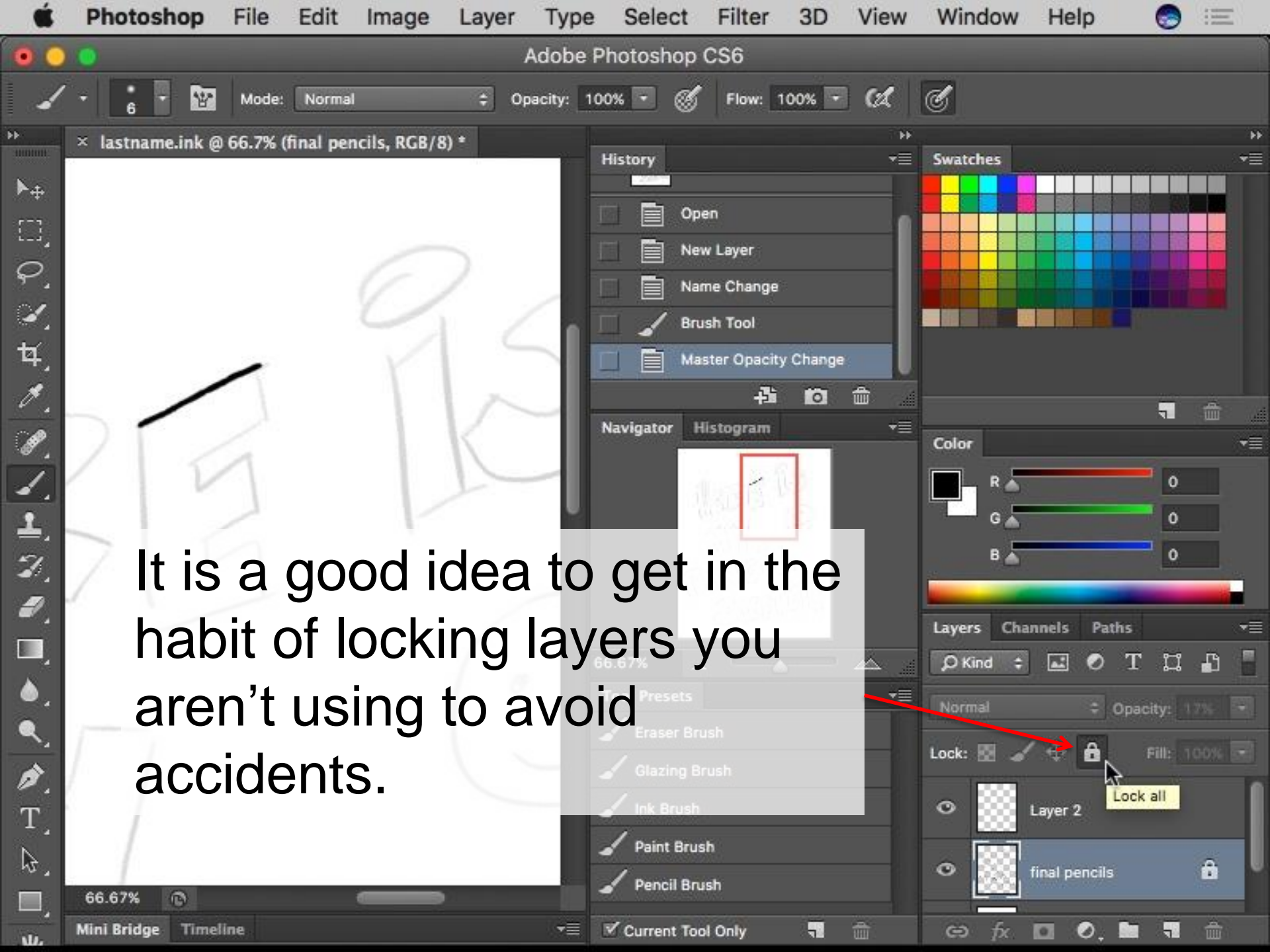

It is a good idea to get in the habit of locking layers you aren't using to avoid accidents.

Lock all

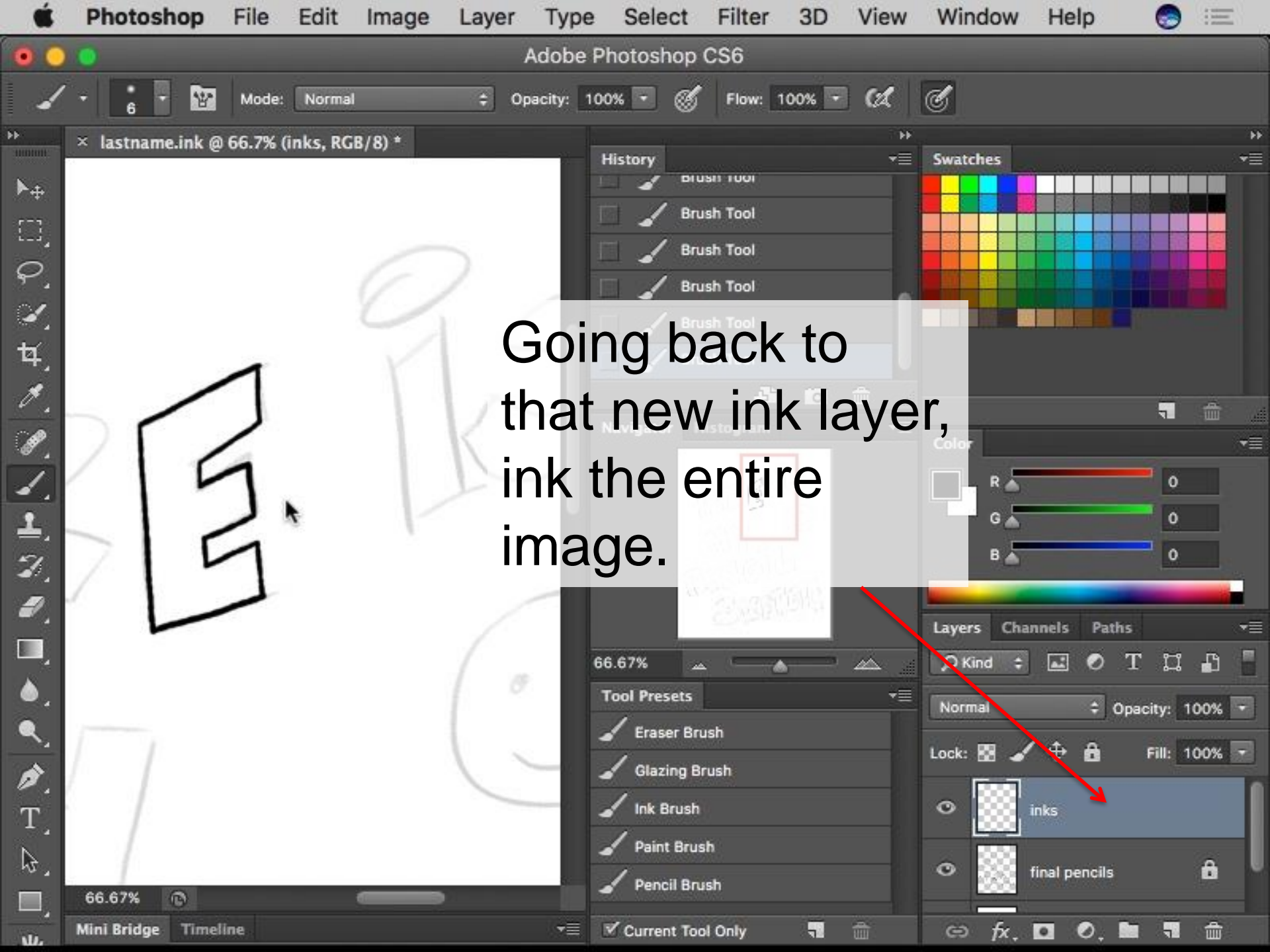

Going back to that new ink layer, ink the entire image.

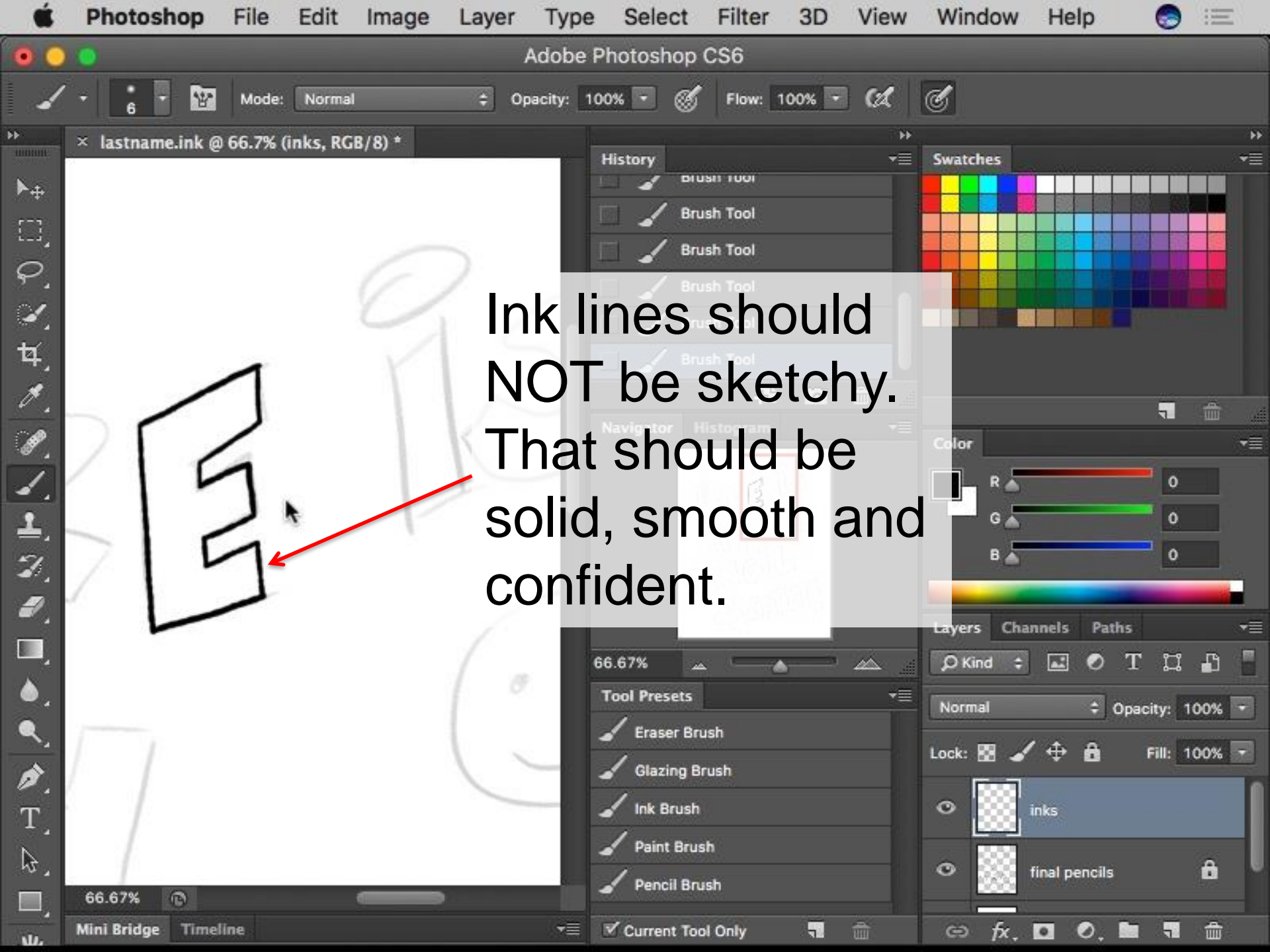

Ink lines should NOT be sketchy. That should be solid, smooth and confident.

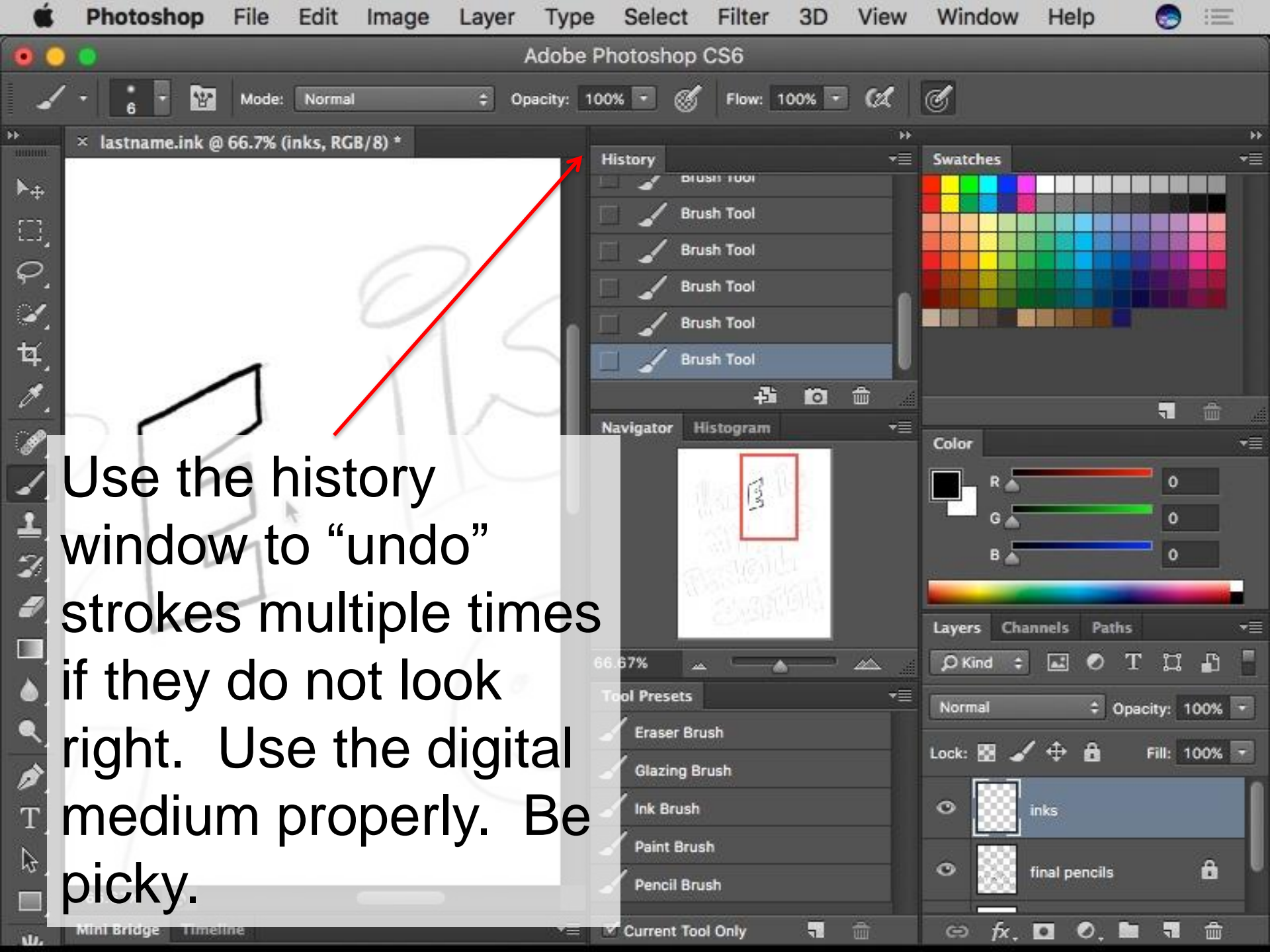

Use the history window to “undo” strokes multiple times if they do not look right. Use the digital medium properly. Be picky.

Digital Ink Image

Objective: Students will be able to demonstrate the necessary understanding and skills in regard to **proper Photoshop use, contour line work with a digital tablet** by creating a **digital ink drawing over a digital pencil sketch**. Students will actively evaluate themselves within the critique criteria of creativity, craftsmanship, following directions, and in-class effort.

Instructions/Steps

1. Open your finished Pencilsketch file from the previous project.
2. "Save As..." a new PSD file named **YourLastName.Ink**
3. This will create a second file for you to work on, leaving your pencil sketch file untouched.
4. Drop the opacity of your pencil sketch layer so you can barely see it.
5. Create a new layer on top of your pencil sketch layer. This is your layer for inking.
6. Using the preset tools for the paintbrush, choose "Ink Brush"
7. Draw over your pencil sketch on the new layer as an ink drawing.
8. The ink lines should be clean and confident, not sketchy. Don't forget to use your history window to step back if a stroke does not look right.