

ADDENDUM NO. 1

Date:	<u>May 7, 2018</u>	Owner:	<u>West Ada School District</u>
Project:	<u>Phase 2 -Rocky Mtn. High School Reroof</u>		
Project No.:	<u>HSA #17.139</u>	No. of Pages	<u>1 + attachments</u>

NOTICE TO ALL BIDDERS

You are hereby notified of the following clarifications of and/or revisions to the Drawings and Specifications for the above-referenced project.

THIS ADDENDUM is hereby made a part of the project requirements and contract documents for the referenced project.

BE SURE to acknowledge it in your Bid Proposal form.

ITEM NO.

General Items

1. Please see the attached Pre-Bid Meeting Attendance Sheet for the Pre-Bid attendees.
2. Bid Date Reminder: **Bids are due May 10, 2018 at 2:00 p.m. West Ada School District Service Center, 1303 E. Central Drive, Meridian, ID.**
3. The following Roofing Manufacturer's Certification Forms have been received and approved:
 - a. Carlisle
 - b. Sika Sarnafil
4. The following Roofing Manufacturer's Certification Forms are not approved:
 - a. Versico
 - b. GAF
 - c. Manville
5. Remove & Reinstall Ductwork as required to install new cover board & single-ply roofing membrane.

Drawings

1. **Detail A501** – Provide new steel ladder per attached Detail A501 to be installed at Roof Area “5B” to “5A,” provide fully adhered walk-pad from existing Roof Hatch to new ladder & at base of ladder on Roof Area “5A”.
2. **Drawing Sheet A1.2 – Enlarged Roof Plan, Roof Area 5, Keynote 10:** Add the following: “Provide new pre-finished joint cover per detail A721.” See attached Detail.

Attachments:

Pre-Bid Meeting Attendance Sheet

Manufacturer Certifications: Carlisle, Sika/Sarnafil

Detail A501

Detail A721

*****END OF ADDENDUM NO. 1*****

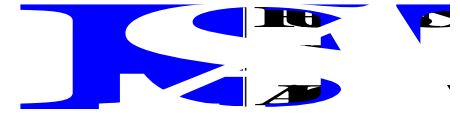

270 N. 27th Street, Suite 200 ▪ Boise, Idaho 83702
T: 208-338-1212 ▪ F: 208-338-0011
www.hsaarchitects.com

Pre-Bid Meeting Attendance

Project No.: 18.100
Project Name: Phase 2 – Rocky Mountain HS Reroof
Location: 5450 N. Linder Road, Meridian, ID 83646
Date and Time: May 3, 2018, 9:00 a.m.

Representative: (please print)	Company: (please print)	Phone:	Email Address: (please print)
Glenn Robinette	HSA	208.338.1212	grobinette@hsaarchitects.com
Tom Doramus	Modern Roofing	208-322-2500	tdoramus@qtrinc.com
Jason Barenberg	Upson Company	208-459-6978	jbarenberg@upsoncompany.com
Mike Chrismer	GAF	208-761-2596	mchrismer@gaf.com
Gary Jenks	Owyhee	208-871-7904	garyj@owyheeheating.com
Mark Rogers	Pro Tech Roofing	208-939-6714	scottlottman@protechroofing.us
Roger Steck	Owyhee	208-871-7925	rogers@owyheeheating.com
Shane VonWald	Signature Roofing	208-409-8332	shane@mysignatureroofing.com
Warren M.	Power Inc.	208-573-1172	wkmcq@msn.com
Thomas Pill	WASD	208-863-6156	Pill.thomas@westada.org
Mitch Laufenberg	Nations Roof	208-488-9286	mlaufenberg@nationsroof.com



May 3, 2018

Revision to April 30, 2018

HSA
270 N. 27th Street, Suite 200
Boise, ID 83702

**Re: Rocky Mountain High School - Phase 2
Roof Areas #4 & #5
Meridian, ID**

To whom it may concern:

This letter is Carlisle SynTec Systems review of the submitted specification for the referenced project. Carlisle has reviewed the following sections only and offers the following recommendations:

Section 07542

Paragraph 1.4.C – no uplift pressures are listed in the specification and none noted on the contract drawings. In addition, not enough information has been submitted to determine uplift pressures. This is to confirm that the listed assembly will meet a 90-lbs/sqft uplift rating (ANSI/FM 4474)

Paragraph 1.8.D – listed assembly will meet UL Class A with a maximum slope of “Unlimited”

Paragraph 1.11.A.2 – The proposed roof assembly will be acceptable for a 55-mph 30-year warranty. Please note that if the existing roofing material (insulation and other components), the performance, integrity and any impact of products not supplied by Carlisle, are not included within the coverage of the membrane system warranty.

Contract Drawing 700 Detail B – Adhered Membrane

Membrane:	80-mil thick reinforced Sure-Flex PVC ¹ Membrane adhered to the cover board with Carlisle PVC Bonding Adhesive
Overlayment:	1/2-inch thick Carlisle DensDeck Prime installed over the insulation and secured through all layers into the deck with Carlisle Insulation Fasteners and Plates ²
Existing:	Existing roofing material ^{3 4}
Deck:	22-ga or heavier steel

Contract Drawings & Details

Please refer to Carlisle published details for warranty installation notes and requirements. If architectural details are more stringent, they should be followed.

¹ The granted option (by Joe Stassi) for this job and is not to be used on any other jobs without prior approval.

This letter must be enclosed with the Notice of Award, failure to do this may result in delay of warranty.

² Securement density per 4’x8’ size board (Field: 12, Perimeter: 12, Corners 12)

³ Existing material reviewed and prepared following good roofing practices

⁴ Unless purchased or supplied through Carlisle, please note that performance, integrity, and impact of products by others, are not included under coverage of the Carlisle Membrane System Warranty.



Upon completion of the Membrane System with CCM required certified accessories in accordance with our current Carlisle System Specifications, and acceptance by Carlisle at final inspection, this project will be eligible for our 55-mph 30-Year Membrane System Warranty.

If you have any questions or if you need further assistance, please feel free to contact our office.

Sincerely,

A handwritten signature in black ink, appearing to read "B. Chamberlain". The signature is fluid and cursive.

Brian P. Chamberlain
Senior Project Analyst

MANUFACTURER'S CERTIFICATION FORM

INSTRUCTIONS

This form is to be submitted to the Architect not less than seven (7) days prior to bid date. For manufacturers not approved in the specifications, they must obtain prior approval of their product in addition to submittal of this form. If a manufacturer indicates exceptions or modifications to the drawings and specification as a condition of acceptance, those exceptions and modifications must be approved by Addendum before the manufacturer may bid on the project.

PROJECT NO. 18.100
Phase 2 - Reroof for
Rocky Mountain High School
5450 North Linder
Meridian, Idaho 83642

MANUFACTURER'S CERTIFICATION

The undersigned roofing manufacturer hereby certifies that he has reviewed the drawings, specifications and conditions of the site and the terms of the roofing guarantee included in the specification and find them acceptable, and if the manufacturer's materials are installed on the project in accordance with the drawings and specifications and upon inspection by the manufacturer's technical representative, manufacturer will issue the guarantee in the form specified.

DATED THIS _____ DAY OF _____, _____

MANUFACTURER

AUTHORIZED REPRESENTATIVE

EXCEPTIONS: Subject to the following exceptions and or modification, (attach any details or added verbiage that is required) the undersigned roofing manufacturer will certify to the conditions stated above:

- Certification is based on specification review and comments. Please review the attached. _____

DATED THIS 4-30-2018 Day of _____, _____

Carlisle SynTec Systems

MANUFACTURER

717-245-7072 Brian Chamberlain  Sr. Project Analyst

AUTHORIZED REPRESENTATIVE

APPROVED APPLICATORS: The following roofing contractors are approved applicators of the roofing system specified (or approved) and as manufactured by the above named manufacturer:

NAME

ADDRESS



May 4, 2018

Phase 2 - Reroof
Rocky Mountain High School 5450 N. Linder Road
Meridian, ID 83646

The following are the "Exceptions" noted on the Manufacturers Certification.

Exhibit A

- Section 07542, 1.11, A, 1: Due to the reuse of the existing roof insulation and related components, they cannot be included in the warranty coverage. Only those products supplied by Sika Sarnafil will be included in the warranty coverage.
- Section 07542, 3.4, G, 1; and, several of the details show/refer to lap sealant. Lap sealant is not required or allowed with Sika Sarnafil systems.
- Detail Sheet 704, 708, 709, 716, 719 & 720 call out for plates and fasteners. We require the use of Sarnastop (peel stop bar) and fasteners around all curbs and walls; no membrane plates.
- Detail Sheet 714: Sika Sarnafil will require attachment (Sarnastop and fasteners) at the top angle change of the canted parapet.
- Detail Sheet 718 shows flashing onto and terminating into the aluminum window framing. Many window frames have weep holes. It would be beneficial to ensure this project doesn't have weep holes.

It is our understanding that the following is the proposed assembly:

- Sarnafil EnergySmart white G410-20 (80 mil) membrane adhered to the cover board Sarnacol Membrane Adhesive.
- 1/2" Dens-Deck Prime cover board mechanically attached to an acceptable substrate at a rate of 1 Sarnafastener #12 and Sarnaplate per 3.2 square feet (10 per 4' x 8' board). Increase fastener density 50% in the defined perimeter areas and 100% in the defined corner areas.
- Existing insulation board (A roof plan showing the replaced wet insulation must be submitted upon completion of the installation.).
- Acceptable substrate.

SIKA CORPORATION • ROOFING

2881 South 900, West · Salt Lake City, UT 84119

Tel: 801-575-8648 • Fax: 801-355-4407 • usa.sarnafil.sika.com

"AS A MEMBRANE MANUFACTURER, SIKA CORPORATION ("SIKA") REVIEWS DETAILS PREPARED BY THE CONSULTANT, ARCHITECT AND/OR ENGINEER FOR A PROJECT SOLELY FOR THE PURPOSE OF DETERMINING IF A SIKA WARRANTY MAY ISSUE FOR THE PROJECT, THIS REVIEW IS NOT TO BE CONSTRUED AS APPROVAL OF DETAILS BY SIKA AND IS NOT BEING CONDUCTED IN LIEU OF SOUND ENGINEERING AND ARCHITECTURAL PRACTICES AND JUDGMENT AND SHOULD NOT BE RELIED UPON FOR THAT PURPOSE. SIKA CORPORATION ASSUMES NO LIABILITY WITH RESPECT TO THE DESIGN OF THE ROOFING OR WATERPROOFING SYSTEM. THE ARCHITECT, CONSULTANT AND/OR ENGINEER OR DESIGN PROFESSIONAL FOR A PARTICULAR PROJECT BEARS THE SOLE RESPONSIBILITY FOR THE DESIGN OF THE ROOFING OR WATERPROOFING SYSTEM, FOR THE PREPARATION AND APPROVAL OF THE DETAILS AND SHOP DRAWING AND FOR DETERMINING THEIR SUITABILITY FOR A PARTICULAR PROJECT OR APPLICATION. WHILE SIKA PROVIDES GENERAL INSTRUCTIONS FOR THE INSTALLATION OF ITS MEMBRANE, AS WELL AS TRAINING FOR SIKA AUTHORIZED APPLICATORS, THE MEANS AND METHODS USED BY THE CONTRACTOR FOR SURFACE PREPARATION, AS WELL AS THE MEANS AND METHODS EMPLOYED BY THE CONTRACTOR IN THE INSTALLATION OF THE SIKA MEMBRANE ARE THE RESPONSIBILITY OF THE CONTRACTOR. ALL SALE OF SIKA PRODUCTS AND SERVICES ARE SUBJECT TO SIKA TERMS AND CONDITIONS OF SALE AVAILABLE AT USASARNAFIL.SIKA.COM"

MANUFACTURER'S CERTIFICATION FORM

INSTRUCTIONS

This form is to be submitted to the Architect not less than seven (7) days prior to bid date. For manufacturers not approved in the specifications, they must obtain prior approval of their product in addition to submittal of this form. If a manufacturer indicates exceptions or modifications to the drawings and specification as a condition of acceptance, those exceptions and modifications must be approved by Addendum before the manufacturer may bid on the project.

PROJECT NO. 18.100
Phase 2 - Reroof for
Rocky Mountain High School
5450 North Linder
Meridian, Idaho 83642

MANUFACTURER'S CERTIFICATION

The undersigned roofing manufacturer hereby certifies that he has reviewed the drawings, specifications and conditions of the site and the terms of the roofing guarantee included in the specification and find them acceptable, and if the manufacturer's materials are installed on the project in accordance with the drawings and specifications and upon inspection by the manufacturer's technical representative, manufacturer will issue the guarantee in the form specified.

DATED THIS 4 DAY OF MAY, 2018
Sika

Joseph Schumf MANUFACTURER

AUTHORIZED REPRESENTATIVE

EXCEPTIONS: Subject to the following exceptions and or modification, (attach any details or added verbiage that is required) the undersigned roofing manufacturer will certify to the conditions stated above:

Notwithstanding the certification set forth above, Sika Corporation has reviewed the drawings and specifications solely for purposes of determining whether Sika Corporation will issue a guarantee for the project. Sika Corporation assumes no liability with respect to site conditions, the design of the roofing or waterproofing systems, the preparation and approval of details and shop drawings and for determining their suitability for a particular project or application based on site conditions. This certification is subject to the Criteria and Exception page(s) attached hereto (Exhibit A).

DATED THIS 4 Day of MAY, 2018
Sika

Joseph Schumf MANUFACTURER

AUTHORIZED REPRESENTATIVE

APPROVED APPLICATORS: The following roofing contractors are approved applicators of the roofing system specified (or approved) and as manufactured by the above named manufacturer:

NAME	ADDRESS
Nations Roof	10621 W Executive Dr., Boise, ID 83713
Upton Company	4512 E Ustik Rd., Caldwell, ID 83605
Quality Tile Roofing	2711 S Curtis RD., Boise, ID 83705
Modern Roofing	8620 Franklin Rd., Boise, ID 83709
Cobra Building Envelope Contractors	6303 Cameo Street, Boise, ID 83709
Pro Tech Roofing	1986 East State, Suite A, Eagle, ID 83616

© 2018 HUTCHISON SMITH ARCHITECTS. ALL RIGHTS RESERVED. THESE DESIGNS AND DRAWINGS ARE THE EXCLUSIVE PROPERTY OF HUTCHISON SMITH ARCHITECTS, AND ARE NOT TO BE USED OR DUPLICATED WITHOUT PERMISSION. COPYRIGHT © 2018, ALL RIGHTS RESERVED.

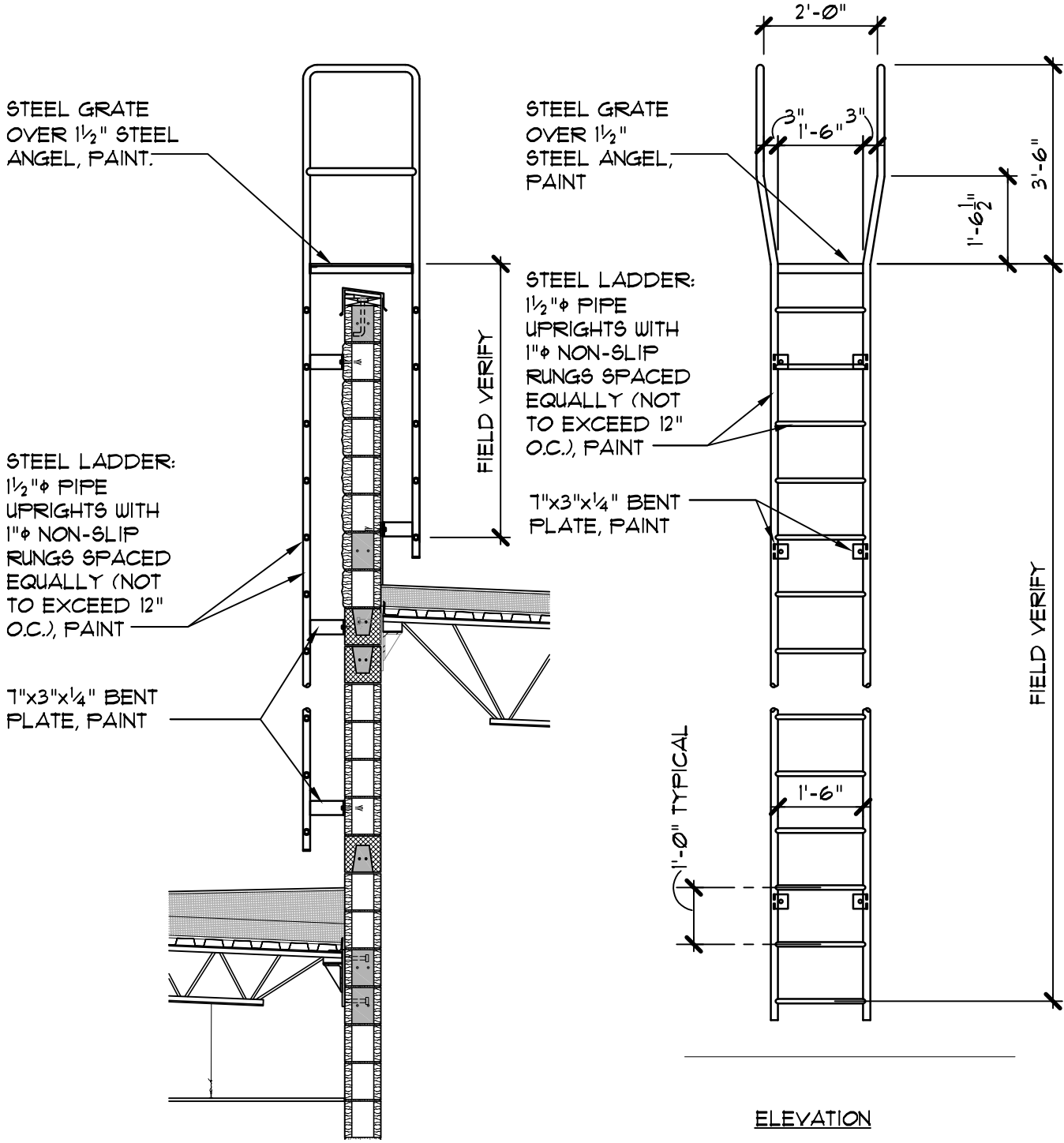

SECTION

A

ROOF ACCESS LADDER

Scale: 1/2" = 1'-0"

HSA HUTCHISON SMITH ARCHITECTS
 270 North 27th St. Boise, ID. 83702 (208) 338-1212 FAX (208) 338-0011 hsaarchitects.com

REVISIONS:

PROJECT: 18-100
DRAWN: GHR
DATE: APRIL 2018

SHEET
501
1818000501A501

THESE DESIGNS AND DRAWINGS ARE THE EXCLUSIVE PROPERTY OF HUTCHISON SMITH ARCHITECTS, AND ARE NOT TO BE USED OR DUPLICATED WITHOUT PERMISSION. COPYRIGHT © 2018, ALL RIGHTS RESERVED.

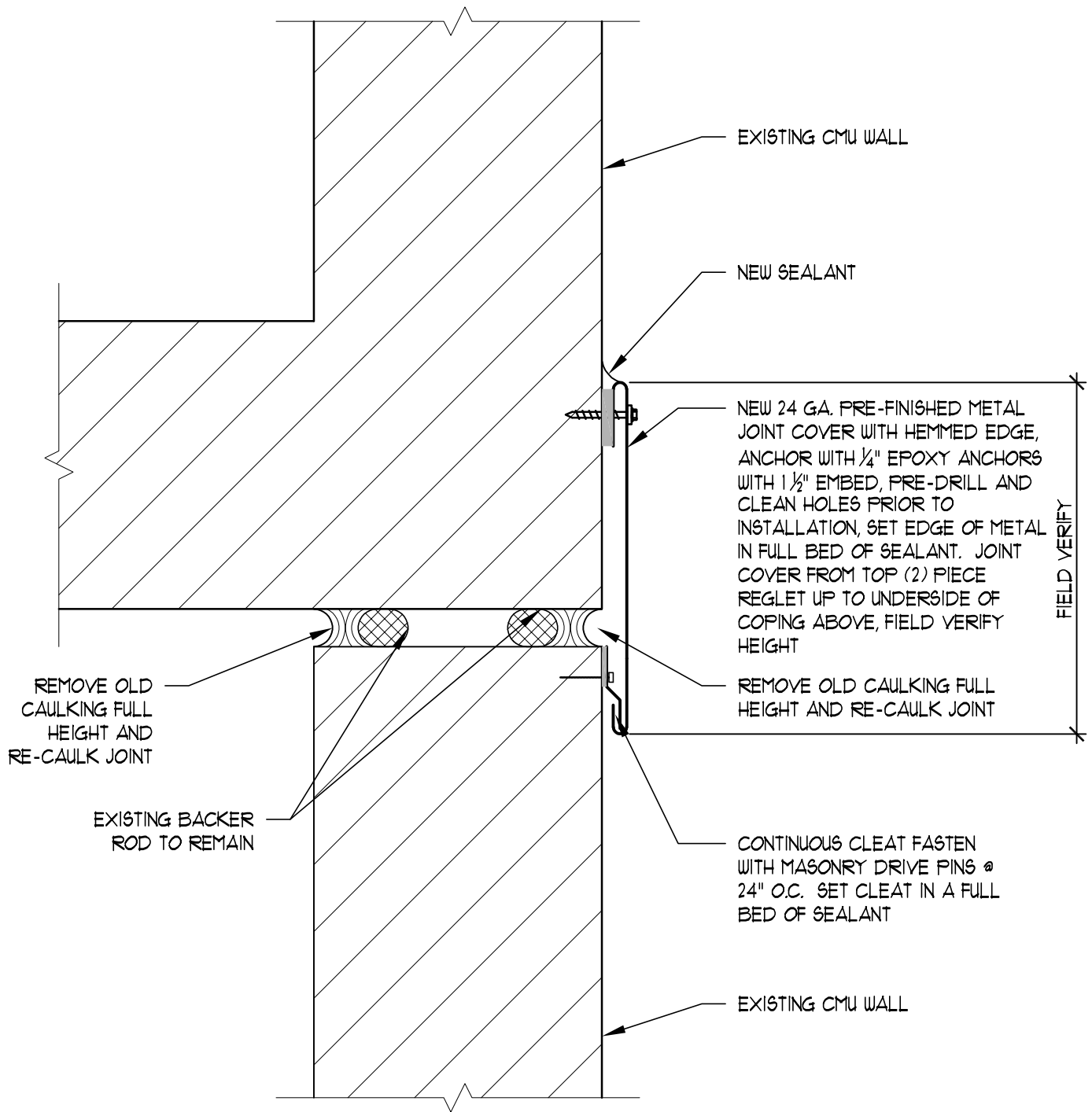

A **JOINT DETAIL**
 SCALE: 3" = 1'-0"

HS HUTCHISON
 SMITH
 ARCHITECTS

270 North 27th St. Boise, ID. 83702 (208) 338-1212 FAX (208) 338-0011 hsaarchitects.com

REVISIONS:

PROJECT:
18-100

DRAWN:

DATE:
APRIL 2018

SHEET

721

18100-A721